



## Open Range Roamer

Serial #: 58TCH0BU7N3JC3085  
Model: 354MBH OPEN RANGE ROAMER FW

Model Year: 2022 Dealer Name: DENNIS DILLON RV  
6560 WEST TARGEE  
BOISE, ID 83709  
USA

### Standard Equipment

### Optional Equipment

THE FOLLOWING ITEMS ARE STANDARD ON THIS MODEL  
AT NO EXTRA CHARGE

OPTIONAL EQUIPMENT INSTALLED BY MANUFACTURER

#### EXTERIOR

- 100" wide body frame
- 2" receiver hitch
- 3-20 lb. LP bottles
- 50 amp service
- ACCU-SLIDE™ slide system (42" deep 4-corner compression)
- Battery disconnect switch
- Brass hanger bushings with wet bolts
- Equa-Flex® axle suspension
- Exterior grill hookup quick connect port
- Laminated block foam floor
- PVC roofing membrane (limited lifetime warranty)
- Roof ladder
- Self-adjusting electric brakes
- Spare tire
- TuffShell™ - vacuum bonded laminated construction, reinforced with heavy-duty fiberglass and welded aluminum frames

#### FOUR SEASON PACKAGE (MANDATORY)

- Double insulated baggage doors
- Ducted heat to underbelly with cold air return
- Enclosed cable operated gate valves
- Enclosed exterior docking station with black tank flush
- Heated and enclosed underbelly
- High performance furnace
- R-38 reflective foil insulation in ceiling and underbelly
- R-9 block foam insulation in sidewalls
- R-9 Insulation in Sidewalls

#### INTERIOR

- 75 lb. ball bearing drawer guides
- 60" X 80" residential size queen bed with adjustable power base
- Cable and satellite prep
- Flush floor slides with residential vinyl flooring
- Large oven and 3-burner range with flush mount glass cover
- LED interior lighting
- Observation camera prep
- Residential microwave
- Roller blackout night shades
- Theater seating with heat and massage
- Wall controlled power vent (kitchen/living room area)
- Washer/dryer prep
- Wi-Fi ready

#### EXECUTIVE PACKAGE (MANDATORY)

- 15,000 BTU roof mounted A/C
- 76" X 28" entrance door
- AM/FM/HDMI/USB/AUX Bluetooth® sound bar stereo with outdoor zones speakers
- Cutting board and sink strainer
- Digital TV antenna
- Interior convenience center light
- Keyed-Alike® entry and baggage doors
- LED HDTV
- Marine grade exterior speakers (2)
- Painted fiberglass front cap with LED lighting and automotive tinted window
- Power awning with LED lighting
- Quick recovery gas/electric water heater
- Quick release fresh water drain
- Residential high-rise faucet with pull-down sprayer
- Single Basin stainless steel under-mount kitchen sink
- Solar prep
- Solid swing-down entry step
- Solid-surface kitchen countertops
- Stainless steel appliances
- TravelINK™ - Smart RV system that allows for Bluetooth® control of awnings, lighting, slides, heating, cooling, auto-levelers and more
- USB/12V Charging Port

Base price  
USA Standards  
Executive Package  
Four Seasons Protection  
Package  
RVIA  
Non-Powered Vent Bedroom  
12 Cu. Ft. Gas/Electric  
Refrigerator  
No Generator Prep  
32" Bedroom TV  
Windows Standard  
Power Fan Vent Wall  
Control (Bathroom)  
BBQ Grill  
4 Point Auto Leveling  
with JT Strong Arms  
Theater Seats with  
Table&Chairs  
Booth Dinette Bunk Room  
2 Additional Dinette  
Folding Chairs  
TV Trays (2)

JN006

GE 2022 HIGHLAND RIDGE OPEN RANGE



58TCH0BU7N3JC3085

UNIT TOTAL

82

DEALER INSTALLED OPTION

# Manufacturer's Suggested Retail Price

\$82,090.00

TOTAL AMOUNT DOES NOT INCLUDE STATE AND LOCAL TAXES OR LICENSE FEES. THE PRICE SHOWN ABOVE MAY OR MAY NOT BE REPRESENTATIVE OF THE ACTUAL SELLING PRICE OF SIMILAR RECREATIONAL VEHICLES IN YOUR AREA.

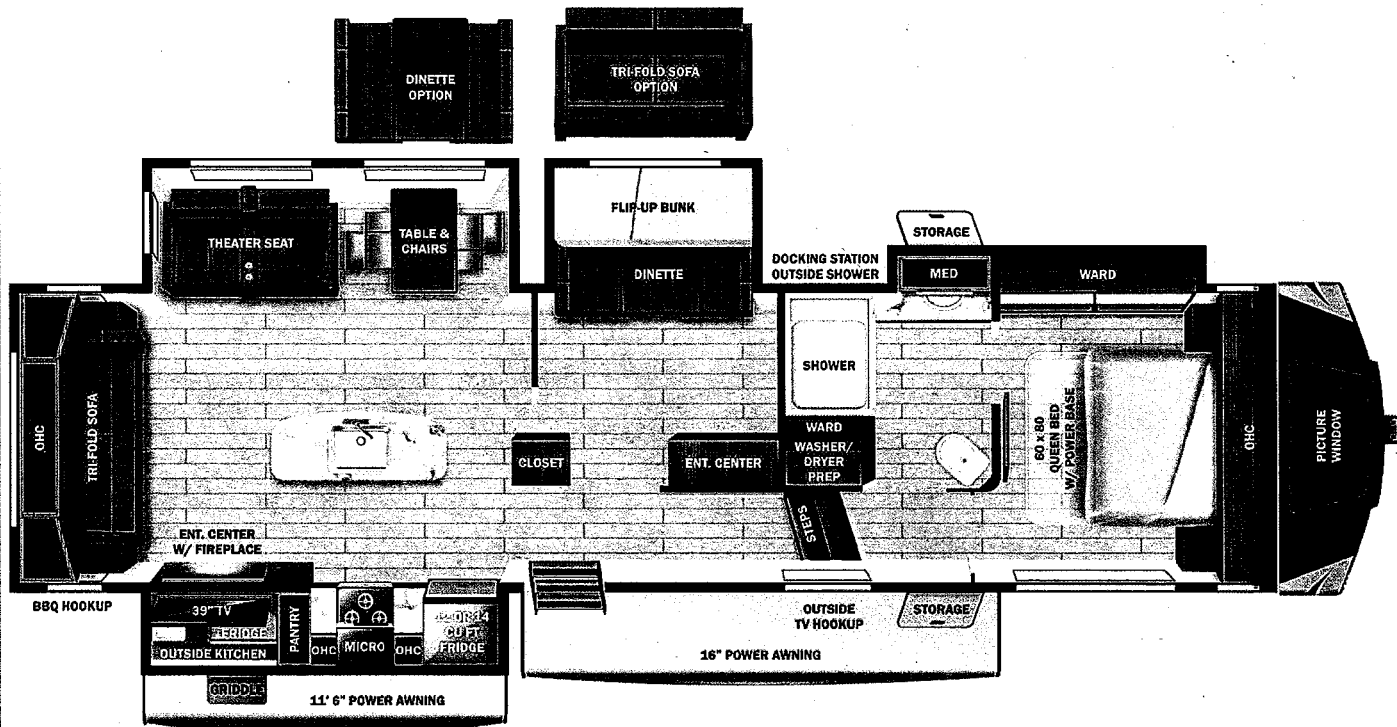

IS VEHICLE

960.00  
n/c  
000.00

750.00  
135.00  
n/c

993.00  
n/c  
893.00  
n/c

375.00  
188.00  
293.00

n/c  
n/c

443.00  
60.00

00.00



**UVW**

11462 lbs



**Sleeps**



**Length**

39' 2.25"

## DIMENSIONS

Exterior height:.....158.38"

Exterior width:.....100.00"

## WEIGHTS

GVWR:.....13500

GAWR (front):.....6000

GAWR (rear):.....6000

Approx. Gross Cargo Carrying Capacity (GCCC):.....2038

## TIRES

Tire size (front):.....ST235/80R16E

Tire size (mid):.....

Tire size (rear):.....ST235/80R16E

## CAPACITIES

Fresh water tank (gals.):...75.00

Gray water tank (gals.):...97.00

Black water/toilet tank (gals.):.....40.00

Propane (lbs.):.....60

Propane (gals.):.....14

Water heater (gals.):.....6.00

## SEATING & SLEEPING

Queen Bed:.....60 X 80

\*\*\*Some dimensions may be rounded and may vary from the actual dimensions\*\*\*

\*\*\*Weights may be estimated calculations and may vary from the actual weight

- refer to the vehicle weight labels for actual weights\*\*\*

Floorplans, features and specifications are subject to change without notice.

**3**  
**YEAR**  
LIMITED  
STRUCTURAL  
WARRANTY